



DE3632-

English

DISCOVERY PIR MCW

Wireless PowerCode PIR Detector



Installation Instructions

1. FEATURES

- Includes a fully supervised PowerCode transmitter
- Patented sophisticated motion analysis algorithm - True Motion Recognition (TMR™)
- Two-position vertical adjustment for coverage pattern
- Integral swivel bracket for wall or ceiling installation
- Programmable motion event counter - ON (default) or OFF
- Front cover tamper switch
- Back tamper switch (option)
- Full stabilization achieved 30 seconds after power up
- After detection, the detector disables itself to save battery power. It reverts to the ready state if there is no subsequent detection throughout the following 2-minute period.

- Automatic termination of walk-test after 15 minutes
- Low current consumption
- Microprocessor-controlled temperature compensation
- Sealed chamber protects the optical system
- White light protection
- Elegantly styled, sturdy case
- Keyhole-shaped slot for easy removal of PCB

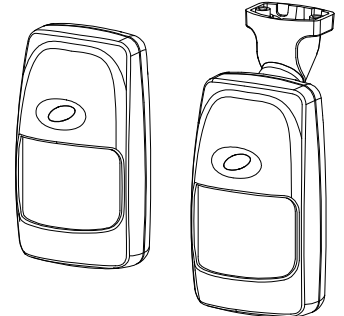

Figure 1. External View

2. SPECIFICATIONS

OPTICAL

Detector Type: Dual element low-noise pyroelectric sensor.

Detection Pattern: 90° wide angle lens with 19 dual zones in 3 detection layers. Max. coverage is 15 x 15 m (50 x 50 ft).

Adjustment: 2-position vertical adjustment scale: FAR and NEAR.

LENS No. 103DH
Max. Coverage: 15 x 15 m / 90°
(50 x 50 ft / 90°)

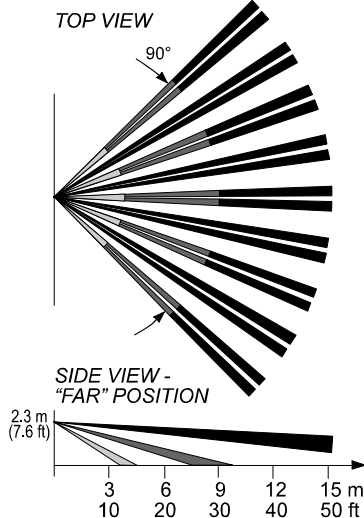

Figure 2. Coverage Pattern

ELECTRICAL

Internal Battery: 3V Lithium battery, type CR-2.

Nominal Battery Capacity: 750 mAh

Standby Current Drain: 0.015 mA

Transmit Current Drain: 20 mA (including LED)

Battery Life Expectancy: 3 years (for typical use)

Battery Supervision: Automatic reporting of battery status with each alarm and with periodic supervision message.

FUNCTIONAL

True Motion Event Verification: 2 position selector - 1 (OFF) or 2 (ON) motion events.

Alarm Period: 3 seconds.

Visual Indications:

LED lights for about 3 seconds upon transmission of alarm & tamper messages and upon each motion detection in the walk test mode.

LED flashes during the power-up stabilization period, or after restoring (pressing) the tamper switch.

LED does not light upon transmission of supervision messages.

Rearm Timer: Rearms the detector 2 minutes after the last alarm. Timer disabled in the walk test mode.

WIRELESS

Frequency (MHz): 315 (U.S. version), 433.92, 868.95, 869.2625 or other frequencies according to local requirements.

Transmission Sequence: 3 data bursts at variable intervals within 3 seconds.

Encoding: 24-bit ID, over 16 million possible combinations.

Total Message Length: 36 bits.

Tamper Alert: Reported when a tamper event occurs and in any subsequent message, until the tamper switch is restored.

Supervision Message: Signaling at 60 minutes interval (U.S. version), 15 minute interval (UK version) or according to local standards.

MOUNTING

Height:

With bracket : Up to 3.6 m (12 ft)

Without bracket: 2 - 2.6 m (6.5 - 8.5 ft)

Installation Options:

With bracket: Surface or ceiling

Without bracket: Surface or corner

Bracket Adjustment: 20° downward, 20° left and right.

ENVIRONMENTAL

RFI Protection: >30 V/m up to 1000 MHz.

Operating Temperatures: -10°C to 50°C (14°F to 122°F).

Storage Temperatures: -20°C to 60°C (-4°F to 140°F).

Compliance with Standards: Designed to comply with FCC Part 15.

PHYSICAL

Dimensions (H x W x D): 117 x 65 x 47 mm.
(4-5/8 x 2-9/16 x 1-7/8 in.).

Weight: 92 g (3.25 oz) without bracket, 107 g (3.75 oz) with bracket.

Color: White

PATENTS: U.S. Patent No. 5,693,943

3. INSTALLATION

3.1 Installation Hints

To minimize false alarms:

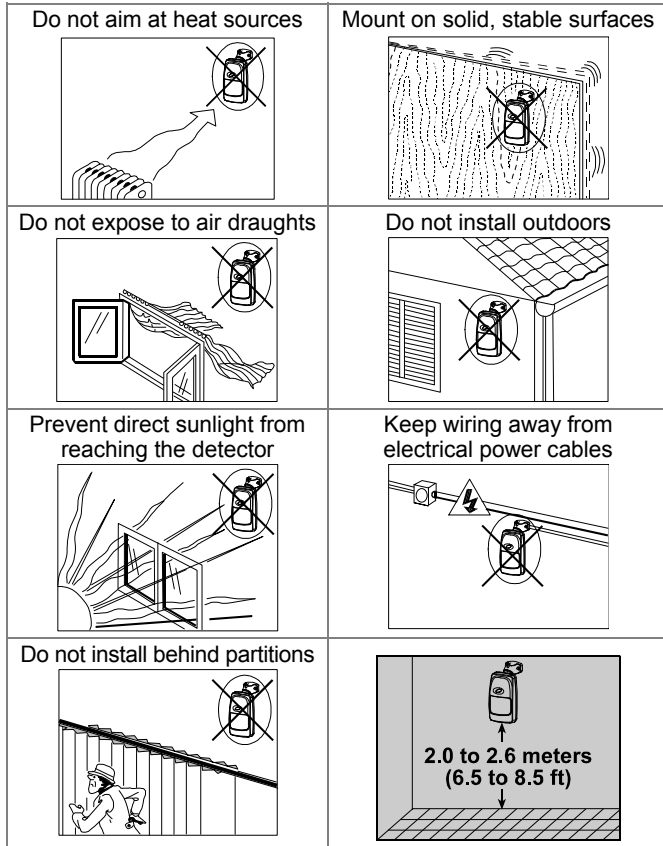

3.2 Battery Insertion

It is recommended to power up the detector and let the target receiver "learn" the transmitter's ID before actual installation. This can be done only after battery installation.

A. Remove the front cover as shown in Figure 3.

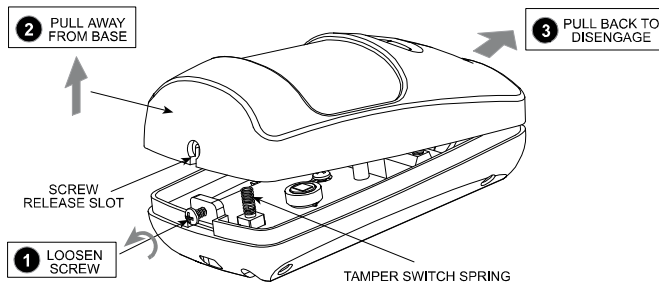

Figure 3. Cover Removal

- B. Insert the battery into the battery clip - observe polarity (see Figure 4).
- C. Press the tamper switch once and release it. This will perform the reset necessary for smooth power up.
- D. Put the cover on and observe the LED. It will flash until the detector stabilizes (within about 30 seconds).

3.3 Enrolling the Transmitter ID

Refer to the target receiver's installation instructions and follow the procedure given there for "teaching" the transmitter's ID. It is much easier to carry out this operation in close proximity to the receiver.

3.4 Mounting without Swivel Bracket

- A. Remove the front cover as shown in Figure 3.
- B. Loosen the vertical adjustment screw, slide the PCB down and remove it via the "keyhole" (see Figure 4).

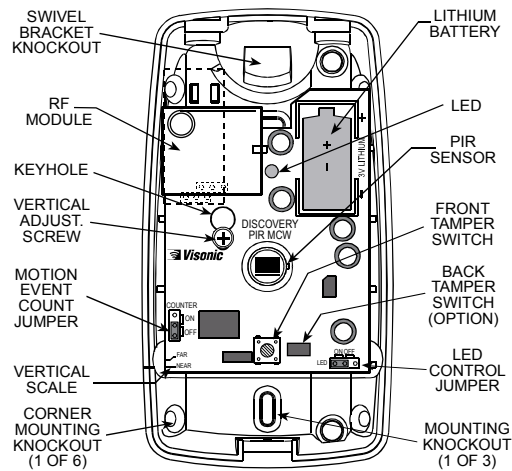

Figure 4. Inside View

C. Punch out the mounting knockouts at the base (for surface mounting) or mounting knockouts at the angled sides of the base (for corner mounting).

Attention! The unit has a back tamper switch (option) under the PCB. As long as the PCB is seated firmly within the base, the switch lever will be pressed against a special break-away base segment that is loosely connected to the base (Figure 5). **Be sure to fasten the break-away segment to the wall.** If the detector unit is forcibly removed from the wall, this segment will break away from the base, causing the tamper switch to open. It is advisable to pierce the anti-tamper knockouts from within the base outward, while pressing the rear surface of the break-away segment against a piece of rear.

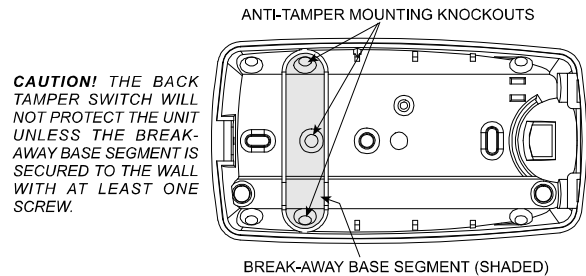

Figure 5. Anti-Tamper Break-Away Base Segment

D. Hold the base against the wall at the selected location, mark the drilling points, drill the holes and attach the base to the wall.

E. Return the PCB to its place: align the "keyhole" with the head of the vertical adjustment screw, press the PCB against the base, slide the PCB up and temporarily tighten the screw.

3.5 Mounting with Swivel Bracket

- A. Remove the front cover as shown in Figure 3.
- B. Loosen the vertical adjustment screw, slide the PCB down and remove it via the "keyhole" (see Figure 4).
- C. Punch out the large knockout in the round bulge at the top part of the base (see Figure 6).
- D. Assemble the bracket as shown in Figure 6.

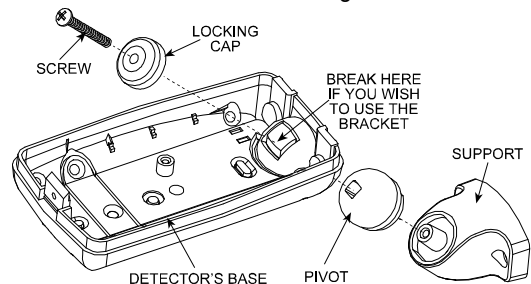

Figure 6. Attaching the Bracket

E. Rotate the bracket to the desired position (see Figure 7) but do not yet tighten the screw fully.

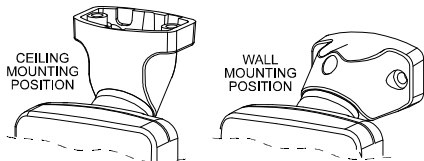

Figure 7. Wall and Ceiling Positions of Bracket

F. Mark the points for drilling through the two mounting holes of the bracket. Attach the bracket to the mounting surface.

G. Tilt down or swivel the detector to face the desired direction. Figure 8 shows the tilt/swivel possibilities.

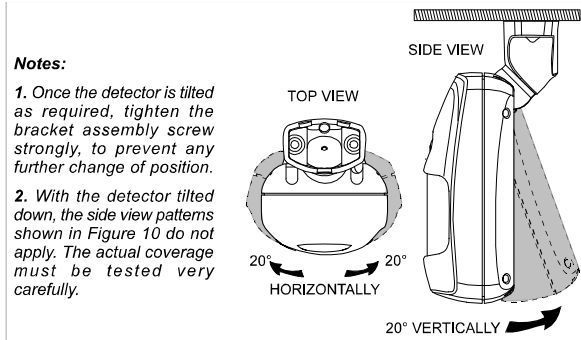

Figure 8. Tilt/Swivel Limits

3.6 Setting the Motion Event Counter

The location of the motion event jumper is shown in Figure 4. Refer to Figure 9 below and mount the jumper as desired.

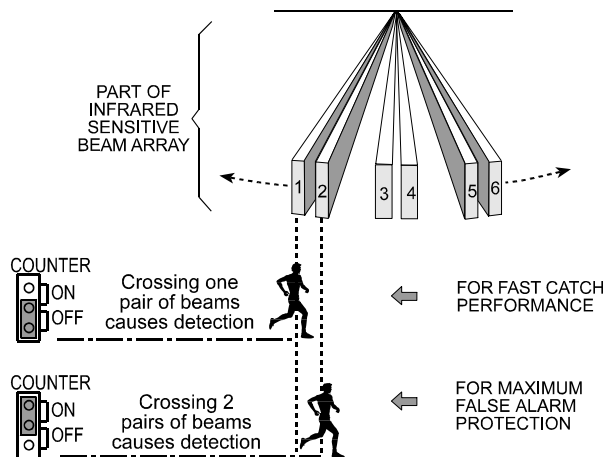

Figure 9. Motion Event Counter Setting Options

3.7 Setting the LED Control Jumper

	ON Position: Setting the jumper as shown enables the LED. Remember that the detector disables itself for 2-minutes after detection!
	OFF Position: Setting the jumper as shown disables the LED.

Note: At power up or reset, the LED flashes for 30 seconds regardless of the jumper position and then enters walk-test mode. After 15 minutes the detector enters normal mode in which the LED functions according to the LED control jumper position..

3.8 Vertical Adjustment

Refer to Figure 10. Loosen the vertical adjustment screw and slide the printed circuit board up or down to obtain the desired coverage. When done, tighten the screw well.

SCALE POSITION	RESULTANT PATTERN	
FAR	Mounting height: 2.0 - 2.6 m (6.5 - 8.5 ft)	Room length: 8 - 15 m (24 - 50 ft)
NEAR	Mounting height: 2.0 - 2.6 m (6.5 - 8.5 ft)	Room length: 3 - 8 m (10 - 24 ft)

Figure 10. Vertical Adjustment

3.9 Walk Testing

Upon battery insertion or closing of the cover (which results in closing of the tamper switch) the detector goes into walk-test mode and automatically exits the mode after 15 minutes.

- Set the motion event counter as required (see Paragraph 3.6).
- Adjust the vertical angle as desired (see Paragraph 3.8).
- Remount the cover and fasten the case closure screw. This results in the resetting of the detector and the start of walk-test mode.
- Wait until the LED stops flashing (about 30 seconds).
- Walk-test the entire protected area by walking slowly across the detector's field of view, observing the LED. Pause for 5 seconds after each detection to allow the detector to complete its 3-transmission sequence; the LED will light for about 3 seconds.
- When the walk-test is completed (after 15 minutes), the detector's setting automatically changes according to the LED control jumper setting.

Notes:

- The OFF setting is recommended to prevent unauthorized people from tracing the detector's coverage pattern.
- If the LED is disabled, you may use the control panel's visual and audible indicators to verify proper function of the detector.

Attention! To assure proper function of the detector, the range and coverage area should be checked at least twice a year. Furthermore, the user should be instructed to perform a walk test at the far end of the coverage pattern to assure an alarm signal prior to each time the alarm system is armed.

4. MISCELLANEOUS COMMENTS

4.1 Product Limitations

Visonic Ltd. wireless systems are very reliable and are tested to high standards. However, due to their low transmitting power and limited range (required by FCC and other regulatory authorities), there are some limitations to be considered:

- A. Receivers may be blocked by radio signals on or near their operating frequencies, regardless of the code selected.
- B. A receiver can only respond to one transmitted signal at a time.
- C. Wireless equipment should be tested regularly to determine whether there are sources of interference and to protect against faults.

4.2 Frequency Allocations for Wireless Devices in European (EU) Countries

- 433.92 MHz has no restriction in any EU member state.
- 315 MHz is not allowed in any EU member state.
- 868.95 MHz (wide band) is allowed in all EU member states.
- 869.2625 MHz (narrow band) is not restricted in any EU member state.

4.3 Compliance with Standards

The 315 MHz model of this device complies with Part 15 of the FCC Rules. Operation is subject to the following two conditions: (1) This device may not cause harmful interference, and (2) this device must accept any interference that may be received, including interference that may cause undesired operation.

The user is cautioned that changes or modifications to the unit, not expressly approved by the party responsible, could void the user's FCC authority to operate the equipment.

WARRANTY

Visonic Limited (the "Manufacturer") warrants this product only (the "Product") to the original purchaser only (the "Purchaser") against defective workmanship and materials under normal use of the Product for a period of twelve (12) months from the date of shipment by the Manufacturer.

This Warranty is absolutely conditional upon the Product having been properly installed, maintained and operated under conditions of normal use in accordance with the Manufacturers recommended installation and operation instructions. Products which have become defective for any other reason, according to the Manufacturers discretion, such as improper installation, failure to follow recommended installation and operational instructions, neglect, willful damage, misuse or vandalism, accidental damage, alteration or tampering, or repair by anyone other than the manufacturer, are not covered by this Warranty.

The Manufacturer does not represent that this Product may not be compromised and/or circumvented or that the Product will prevent any death and/or personal injury and/or damage to property resulting from burglary, robbery, fire or otherwise, or that the Product will in all cases provide adequate warning or protection. The Product, properly installed and maintained, only reduces the risk of such events without warning and it is not a guarantee or insurance that such events will not occur.

THIS WARRANTY IS EXCLUSIVE AND EXPRESSLY IN LIEU OF ALL OTHER WARRANTIES, OBLIGATIONS OR LIABILITIES, WHETHER WRITTEN, ORAL, EXPRESS OR IMPLIED, INCLUDING ANY WARRANTY OF MERCHANTABILITY OR FITNESS FOR A PARTICULAR PURPOSE, OR OTHERWISE. IN NO CASE SHALL THE MANUFACTURER BE LIABLE TO ANYONE FOR ANY CONSEQUENTIAL OR INCIDENTAL DAMAGES FOR BREACH OF THIS WARRANTY OR ANY OTHER WARRANTIES WHATSOEVER, AS AFORESAID.

THE MANUFACTURER SHALL IN NO EVENT BE LIABLE FOR ANY SPECIAL, INDIRECT, INCIDENTAL, CONSEQUENTIAL OR PUNITIVE DAMAGES OR FOR LOSS, DAMAGE, OR EXPENSE, INCLUDING LOSS OF USE, PROFITS, REVENUE, OR GOODWILL, DIRECTLY OR INDIRECTLY ARISING FROM PURCHASER'S USE OR INABILITY TO USE THE PRODUCT, OR FOR LOSS OR DESTRUCTION OF OTHER PROPERTY OR FROM ANY OTHER CAUSE, EVEN IF MANUFACTURER HAS BEEN ADVISED OF THE POSSIBILITY OF SUCH DAMAGE.

THE MANUFACTURER SHALL HAVE NO LIABILITY FOR ANY DEATH, PERSONAL AND/OR BODILY INJURY AND/OR DAMAGE TO PROPERTY OR OTHER LOSS WHETHER DIRECT, INDIRECT, INCIDENTAL, CONSEQUENTIAL OR OTHERWISE, BASED ON A CLAIM THAT THE PRODUCT FAILED TO FUNCTION.

However, if the Manufacturer is held liable, whether directly or indirectly, for any loss or damage arising under this limited warranty, **THE MANUFACTURER'S MAXIMUM LIABILITY (IF ANY) SHALL NOT IN ANY CASE EXCEED THE PURCHASE PRICE OF THE PRODUCT**, which shall be fixed as liquidated damages and not as a penalty, and shall be the complete and exclusive remedy against the Manufacturer.

When accepting the delivery of the Product, the Purchaser agrees to the said conditions of sale and warranty and he recognizes having been informed of.

Some jurisdictions do not allow the exclusion or limitation of incidental or consequential damages, so these limitations may not apply under certain circumstances.

The Manufacturer shall be under no liability whatsoever arising out of the corruption and/or malfunctioning of any telecommunication or electronic equipment or any programs.

The Manufacturers obligations under this Warranty are limited solely to repair and/or replace at the Manufacturer's discretion any Product or part thereof that may prove defective. Any repair and/or replacement shall not extend the original Warranty period. The Manufacturer shall not be responsible for dismantling and/or reinstallation costs. To exercise this Warranty the Product must be returned to the Manufacturer freight pre-paid and insured. All freight and insurance costs are the responsibility of the Purchaser and are not included in this Warranty.

This warranty shall not be modified, varied or extended, and the Manufacturer does not authorize any person to act on its behalf in the modification, variation or extension of this warranty. This warranty shall apply to the Product only. All products, accessories or attachments of others used in conjunction with the Product, including batteries, shall be covered solely by their own warranty, if any. The Manufacturer shall not be liable for any damage or loss whatsoever, whether directly, indirectly, incidentally, consequentially or otherwise, caused by the malfunction of the Product due to products, accessories, or attachments of others, including batteries, used in conjunction with the Products. This Warranty is exclusive to the original Purchaser and is not assignable.

This Warranty is in addition to and does not affect your legal rights. Any provision in this warranty which is contrary to the Law in the state or country where the Product is supplied shall not apply.

Warning: The user must follow the Manufacturer's installation and operational instructions including testing the Product and its whole system at least once a week and to take all necessary precautions for his/her safety and the protection of his/her property.

1/08



W.E.E. Product Recycling Declaration

For information regarding the recycling of this product you must contact the company from which you originally purchased it. If you are discarding this product and not returning it for repair then you must ensure that it is returned as identified by your supplier. **This product is not to be thrown away with everyday waste.** Directive 2002/96/EC Waste Electrical and Electronic Equipment.



Visonic

EMAIL: info@visonic.com

INTERNET: www.visonic.com

©VISONIC LTD. 2014 DISCOVERY PIR MCW DE3632- (REV. 7, 8/14)



DE3632-

